



£2,300 PCM
Maytrees
Hitchin, SG4 9LR

PROPERTY SUMMARY

Nestled in the charming area of Maytrees, Hitchin, this delightful detached house offers a perfect blend of comfort and space for family living. With four well-proportioned bedrooms, this property is ideal for those seeking a home that accommodates both relaxation and practicality.

Upon entering, you are greeted by two inviting reception rooms, providing ample space for entertaining guests or enjoying quiet family evenings. The layout of the house promotes a warm and welcoming atmosphere, making it easy to envision creating lasting memories within its walls.

The property features a well-appointed bathroom, ensuring convenience for all residents. The outdoor space is complemented by parking for one vehicle, adding to the practicality of this lovely home.

Maytrees is a sought-after location, known for its friendly community and proximity to local amenities, schools, and parks. This house presents an excellent opportunity for those looking to settle in a peaceful yet vibrant neighbourhood.

In summary, this detached house in Maytrees, Hitchin, is a wonderful choice for families or individuals seeking a spacious and comfortable living environment. With its generous bedrooms, inviting reception areas, and convenient location, it is a property that truly deserves your attention.

4



1



2







PUTTERILLS
LETTINGS
est. 1992





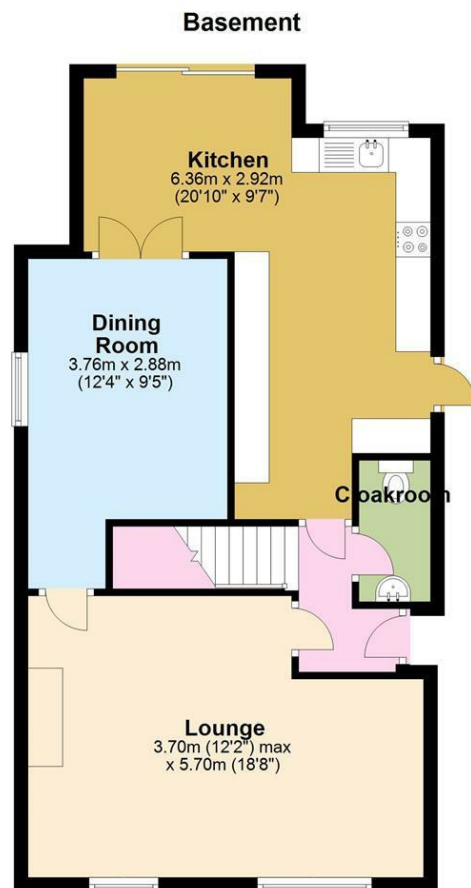

Please note that although all efforts have been made to provide accurate measurements and positioning of fixtures, this floorplan is for marketing purposes and is to be used as a guide only.
©MatherMarshall

Plan produced using PlanUp.

LOCAL AUTHORITY

TENURE

COUNCIL TAX BAND

E

VIEWINGS

By prior appointment only

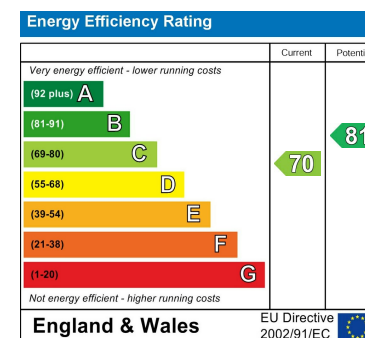

Agents Note: Whilst every care has been taken to prepare these particulars, they are for guidance purposes only. All measurements are approximate and are for general guidance purposes only and whilst every care has been taken to ensure their accuracy, they should not be relied upon and potential buyers/tenants are advised to recheck the measurements



OFFICE ADDRESS

Hill House 1 St Albans Road
Codicote
SG4 8UT

OFFICE DETAILS

01462 419333
lettings@putterills.co.uk
www.putterills.co.uk